

Franklyn James



18 Alpha Grove

, London, E14 8LH

Guide Price £635,000

Guide price £635,000 - £650,000. Franklyn James are pleased to offer this rarely available, freehold, three-bedroom cottage. The property comprises of main hallway leading into the spacious kitchen/diner, with patio doors leading out onto a stunning south facing garden. Further down the hall you will find a spacious living area as well as a downstairs WC. The first floor consists of three good size bedrooms and a well presented four-piece family bathroom. Further benefits include a brand-new boiler with central heating, and double-glazed windows that open both inwards and outwards. Situated moments away from central Canary Wharf the location ensures a peaceful and tranquil lifestyle within walking distance of the river Thames as well as close transport links including South Quay DLR station, and Canary Wharf's jubilee line. Video walk through is available!

- Freehold house
- Three bedrooms
- Separate WC
- Large private garden
- Over a 1000 sqft of internal area
- Great transport links

Viewing

Please contact our Westferry Sales Office on 02070056080 if you wish to arrange a viewing appointment for this property or require further information.



Floor Plan

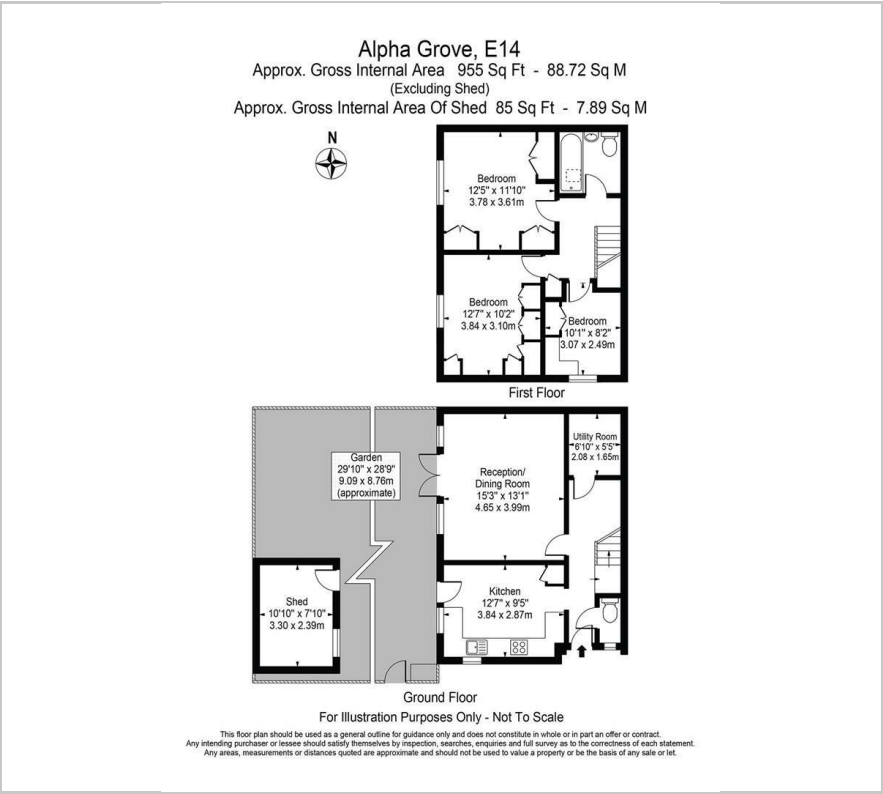

Area Map



Energy Efficiency Graph

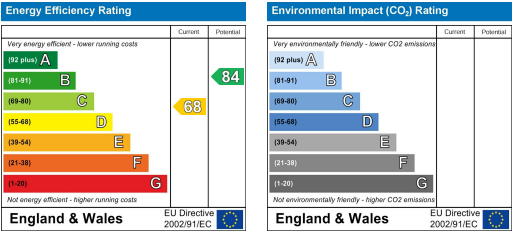

These particulars, whilst believed to be accurate are set out as a general outline only for guidance and do not constitute any part of an offer or contract. Intending purchasers should not rely on them as statements of representation of fact, but must satisfy themselves by inspection or otherwise as to their accuracy. No person in this firm's employment has the authority to make or give any representation or warranty in respect of the property.